

# How to use your charging station

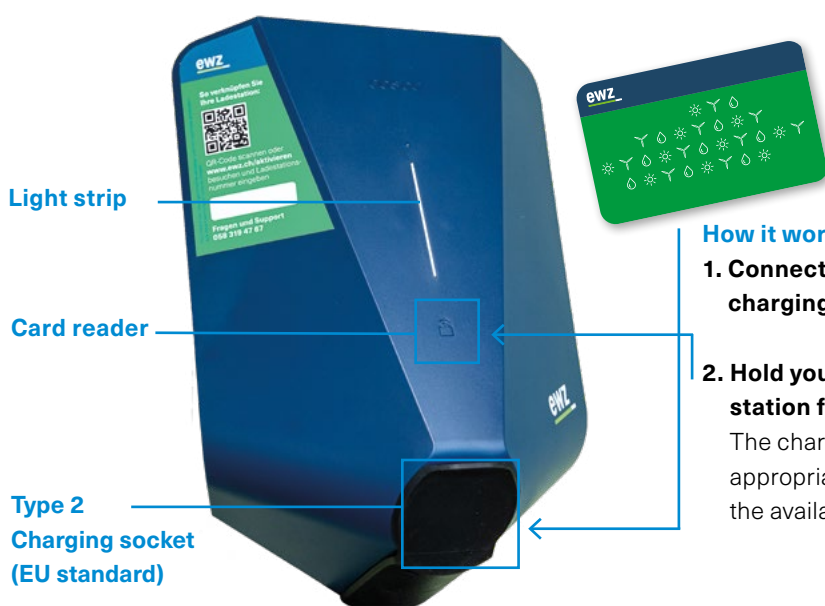

## How it works:

**1. Connect the charging cable to both the charging station and your electric vehicle.**

**2. Hold your charging card up to the charging station for identification.**

The charging station automatically selects the appropriate settings for your electric vehicle and the available electricity.

Explanation of light strip functions	
White – blinking	Waiting for authentication
White – fast blinking	Card has been read (waiting for verification)
White – continuous	Car connected
White – pulsing	Charging in progress
Light at the bottom of the light strip	Standby

## If the charging process does not work straight away, check if

- the charging function in your car is activated,
- all plugs are properly connected and
- the light strip on the charging station is glowing white.

A brief red blinking light following authentication indicates that your charging card was not recognised. Try again. Please check whether you have successfully completed your registration on our **app, ewz mobil**, or at <https://register.ewz-mobil.ch/register>. If the blinking light continues for longer than five minutes or starts again during the charging process, please contact us on our hotline.

## Support hotline 058 319 47 67

If something's not working, we're here to help – day or night.